

**\*\*AVAILABLE IMMEDIATELY\*\* \*\*THIRD FLOOR APARTMENT WITH VIEWS OF RIVER TYNE\*\* \*\*FURNISHED\*\* \*\*BRAND NEW FURNITURE THROUGHOUT\*\***

Originally constructed in 2004, a stylish apartment within Baltic Quay on Gateshead Quays. Located to the third floor, with windows all benefitting from fabulous views and available on a furnished basis, perfect for professionals.

With lift access and boasting in excess of 700 Sq. ft the accommodation briefly comprises: entrance lobby through to entrance hall with built in storage; a contemporary 18ft open-plan living space with lounge/diner, kitchen with integrated appliances including a dishwasher; balcony with astro-turf and panoramic views of the river including the Millennium & Tyne Bridges, The Baltic Art Centre and Sage Gateshead; master bedroom with en-suite shower room WC; second double bedroom with a pleasant green outlook; stylish bathroom with WC. Well presented with brand new furniture supplied throughout, off street parking available in it's own secure car park, this great apartment demands an early internal inspection.

Available Immediately | £1,200pcm | Third Floor Apartment | 729 Sq. ft (67.7m<sup>2</sup>) | Panoramic River Views | Two Bedrooms | Brand New Furniture | Bathroom & En-Suite | 18ft Open Plan Living Space | Balcony with Views | Kitchen With Integrated Appliances | Secure Garage Parking | Furnished | Great Location | DG & Elec Heating | Council Tax Band: D | EPC Rating: C

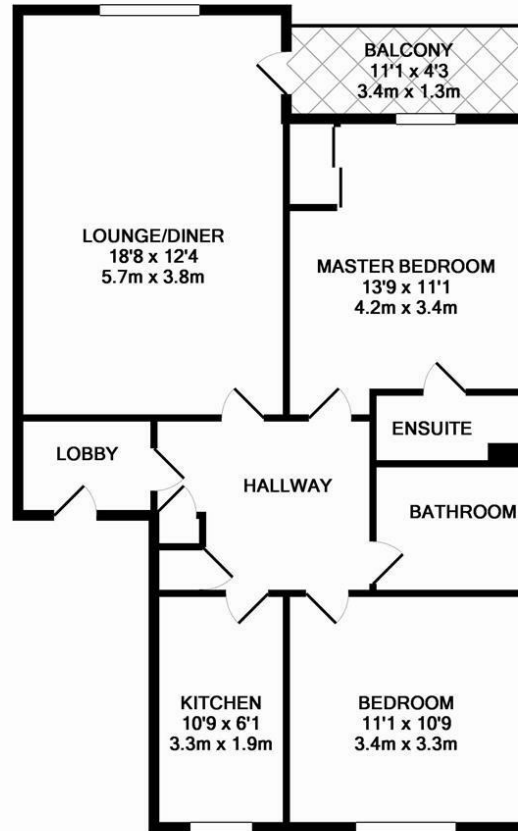

TOTAL APPROX. FLOOR AREA 729 SQ.FT. (67.7 SQ.M.)

Whilst every attempt has been made to ensure the accuracy of the floor plan contained here, measurements of doors, windows, rooms and any other items are approximate and no responsibility is taken for any error, omission, or mis-statement. This plan is for illustrative purposes only and should be used as such by any prospective purchaser. The services, systems and appliances shown have not been tested and no guarantee as to their operability or efficiency can be given  
Made with Metropix ©2015

**£1,200 PCM**

**IMPORTANT NOTE:** These particulars and the descriptions and measurements herein do not constitute representation and whilst every effort has been made to ensure accuracy, this cannot be guaranteed.

